

ClearCatch PANELS - SAMPLE DRAWINGS

SHEET INDEX (ClearCatch PANELS)		
SHEET NO.	CONTENTS	REVISION
CVR	COVER SHEET - INDEX	
NTS	GENERAL NOTES & SPECIFICATIONS	
1.01	PLAN VIEW	
2.01, 2.02	TYPICAL ClearCatch INSTALLATION DETAILS	
3.01-3.02	STANDARD ClearCatch ASSEMBLY DETAILS	
3.03	SPECIAL ClearCatch ASSEMBLY DETAILS	

COPYRIGHT 2022 TRUETECH BRIDGE®, LLC

COPYRIGHT 2022 TRUETECH BRIDGE®, LLC

GENERAL NOTES

DESIGN NOTES

1. THE DESIGN CONTAINED IN THESE DRAWINGS IS BASED ON INFORMATION PROVIDED BY OTHERS. ON THE BASIS OF THE INFORMATION, TRUETECH BRIDGE® IS RESPONSIBLE FOR THE SUPPLY OF THE CLEARCATCH PANELS FOR THE PURPOSE OF PREVENTING ANY DETERIORATED BRIDGE DECK MATERIAL FROM FALLING ON PROPERTY OF PEOPLE BELOW.

2. THE DESIGN, MATERIALS AND CONSTRUCTION ARE BASED ON THE MICHIGAN DOT SPECIAL PROVISION FOR FALSE DECKING, AND SUCCESSFUL PASSING OF THE MDOT DROP TEST COMPLETED ON 4/11/2022.

3. CONTRACTOR IS RESPONSIBLE FOR VERIFYING EXISTING BRIDGE DIMENSIONS AND PANEL FIT AS DETAILS IN THESE DRAWINGS.

INSTALLATION NOTES

1. SECURE CLEARCATCH PANELS TO THE BOTTOM FLANGE BEFORE APPLYING ANY LOAD OR WALKING ON THE PANEL, AND BEFORE THE END OF EACH WORK SHIFT. IT IS RECOMMENDED TO CONNECT CLEARCATCH PANELS IMMEDIATELY UPON PLACEMENT TO PREVENT MOVEMENT OR UPLIFT.

2. CUTTING OR DRILLING OF THE CLEARCATCH PANEL MAY ONLY BE DONE BY ACCEPTABLE METHODS WITH APPROVAL BY TRUETECH BRIDGE AND THE ENGINEER. CUTTING BY TORCH OR BURNING IS NOT PERMITTED.

3. THE MASKING, PROVIDED ON THE TOP SURFACE OF THE CLEARCATCH PANEL, SHOULD BE LEFT ON UNTIL THE PANEL IS READY TO BE PLACED, TO PROVIDE PROTECTION OF THE TRANSPARENT SURFACE. USE ONLY PLASTIC PUTTY KNIVES OR SCRAPERS TO REMOVE MASKING AND TAKE CARE NOT TO SCRATCH THE SURFACE OF THE CLEARCATCH PANEL.

4. ALL SCREWS MUST BE PLACED SUCH THAT THERE IS A MINIMUM DISTANCE OF 0.30 INCHES BETWEEN THE CENTER OF SCREW AND ANY MATERIAL EDGE.

5. THE CONTRACTOR SHALL PROTECT THE INSTALLED CLEARCATCH PANELS FROM ANY CLEANING SOLUTIONS, SOLVENTS SUCH AS ACETONE, GASOLINE, ALCOHOL OR THINNERS AS THEY MAY DAMAGE THE PANEL. ANY PANELS THAT ARE DAMAGED FROM LACK OF PROTECTION SHALL BE REPAIRED OR REPLACED, AS DIRECTED BY THEN ENGINEER.

6. TRUETECH BRIDGE SUPPLIES THE CLEARCATCH PANEL AND COMPONENTS FOR THE STRUCTURE DETAILED HEREIN. IT IS THE CONTRACTORS OBLIGATION TO PREPARE AND EXECUTE A PROJECT SPECIFIC INSTALLATION SEQUENCE, MATERIAL UNLOADING, HANDLING AND BRACING AND FALL PROTECTION SYSTEM. THE NOTES AND DRAWINGS HEREIN DO NOT RELIEVE THE CONTRACTOR OF HIS RESPONSIBILITY TO CONSTRUCT THE FALSE DECKING ACCORDING THE PROJECT PLANS AND SPECIFICATIONS AND CONTRACT DOCUMENTS OR COMPLIANCE WITH ALL FALL PROTECTION, SAFETY, LAWS, STANDARDS AND PROCEDURES REQUIRED.

STORAGE & HANDLING

1. STORE PALLETS OF CLEARCATCH PANELS AT LEAST THREE INCHES OFF THE GROUND WITH ONE END ELEVATED TO ALLOW FOR DRAINAGE.

2. KEEP WRAP ON PALLETS UNTIL PANELS ARE READY FOR INSTALLATION TO REDUCE POTENTIAL FOR DAMAGE.

3. CARE SHALL BE TAKEN TO AVOID DAMAGE TO THE CLEARCATCH PANELS DURING HANDLING AND INSTALLATION. DO NOT STACK MATERIALS, DROP TOOLS OR RUN HEAVY EQUIPMENT OVER THE PANELS. ANY DAMAGED PANELS MUST BE REPLACED BY THE CONTRACTOR PRIOR TO CONTINUING WITH FALSE DECKING CONSTRUCTION.

4. LIFT CLEARCATCH PANELS FROM BENEATH THE STEEL TRACK. DO NOT LIFT FROM THE PLASTIC SHEET.

MATERIAL NOTES

1. ONLY THE MATERIALS SHOWN IN THE TABLE "MATERIALS PROVIDED BY TRUETECH BRIDGE®" WILL BE SUPPLIED BY TRUETECH BRIDGE®. ANY OTHER MATERIALS REQUIRED TO CONSTRUCT THE FALSE DECKING ACCORDING TO THE CONTRACT DRAWINGS AND SPECIFICATIONS SHALL BE SUPPLIED BY THE CONTRACTOR.

MATERIALS PROVIDED BY TRUETECH BRIDGE®

ClearCatch Panels	*MEMBER LENGTH (INCHES)	*MEMBER DEPTH (INCHES)	WIDTH (INCHES)	MIL THICKNESS MILS (1/1000")	YIELD STRENGTH (MIN.) (KSI)	DESIGNATION/ PART ID	COATING	MATERIAL SPECIFICATION
STRUCTURAL STEEL JOIST	VARIES (9'-0" MAX.)	3.625	1.625	54	50	362S162-54	G90	ASTM A653
<div>C-SECTION</div>								
STRUCTURAL STEEL TRACK	48.00	3.625	2.0	33	33	362T200-33	G90	ASTM A653
<div>C-SECTION</div>								
STRUCTURAL STEEL PLATE	4.00	2.00	3.50	10 Ga.	50	PL2 - 10 Ga.	G60 OR HDG TO ASTM A123	ASTM A653 ASTM A1011
<div>HOLD-DOWN CLIP</div>								
#10 SELF-TAPPING SCREW	0.50 (MIN.)						STAINLESS	ASTM A380
<div></div>								
TRANSPARENT POLYCARBONATE	VARIES		47.5 (MIN.) TO 48 (MAX.)	220				ASTM D6098
<div></div>								

PATENT NUMBER: PENDING

ClearCatch - SAMPLE DRAWING

ClearCatch Panels

GENERAL NOTES
& SPECIFICATIONS

01/31/2024

SET

PAGE #

S NTS

COPYRIGHT 2022 TRUETECH BRIDGE®, LLC

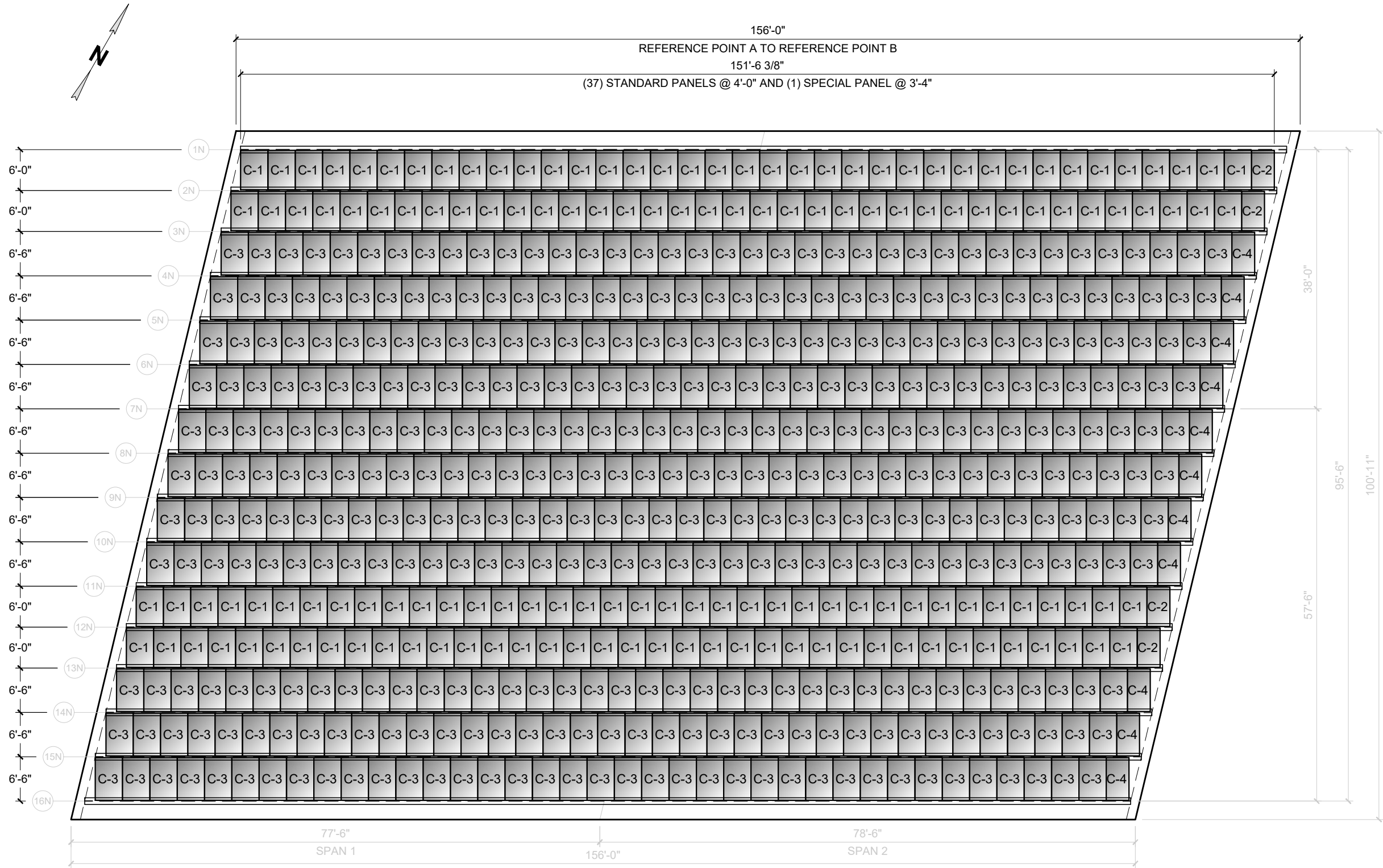

PANEL LAYOUT @ STIFFENER NOTES:

- ① CONTRATOR MAY NEED TO MODIFY PANELS TO REDUCE WIDTH AT BEARING STIFFENER LOCATIONS TO FIT. JOISTS MAY BE SAW-CUT IN-FIELD, THEN RECONNECTED TO TRACK USING SELF-TAPPING SCREWS.
- ② ClearCatch PANEL (TYP.)
- ③ BOTTOM FLANGE OF STEEL GIRDER.

NOTE:
BOTTOM FLANGE WIDTHS ASSUMED TO BE 1'-0" (TYP.),
SEE CONTRACT PLANS FOR ADDITIONAL DETAILS

NOTE: THIS DRAWING AND THE INFORMATION CONTAINED AND/OR DEPICTED HEREIN, EITHER EXPRESSLY OR IMPLIED, IS CONDITIONAL AND PROPRIETARY AND MAY NOT BE REUSED, REPRINTED, DISTRIBUTED OR OTHERWISE DISCLOSED WITHOUT THE EXPRESS WRITTEN CONSENT OF TRUETECH BRIDGE®, LLC.

PREPARED BY:
TrueTech Bridge®
740 Merritt Capital Drive - Suite 121
Wake Forest, NC 27587
Ph.: (855)200-8304

DESIGN BY: DB
DRAWN BY: SE
CHECKED BY: MP

PROJECT NAME:

ClearCatch - SAMPLE DRAWING

PATENT NUMBER: PENDING

ClearCatch Panels

PAGE NAME:

PLAN VIEW

SUBMITTAL DATE:

01/31/2024

PROJECT NO.:

SET

PAGE #

S 1.01

COPYRIGHT 2022 TRUETECH BRIDGE®, LLC

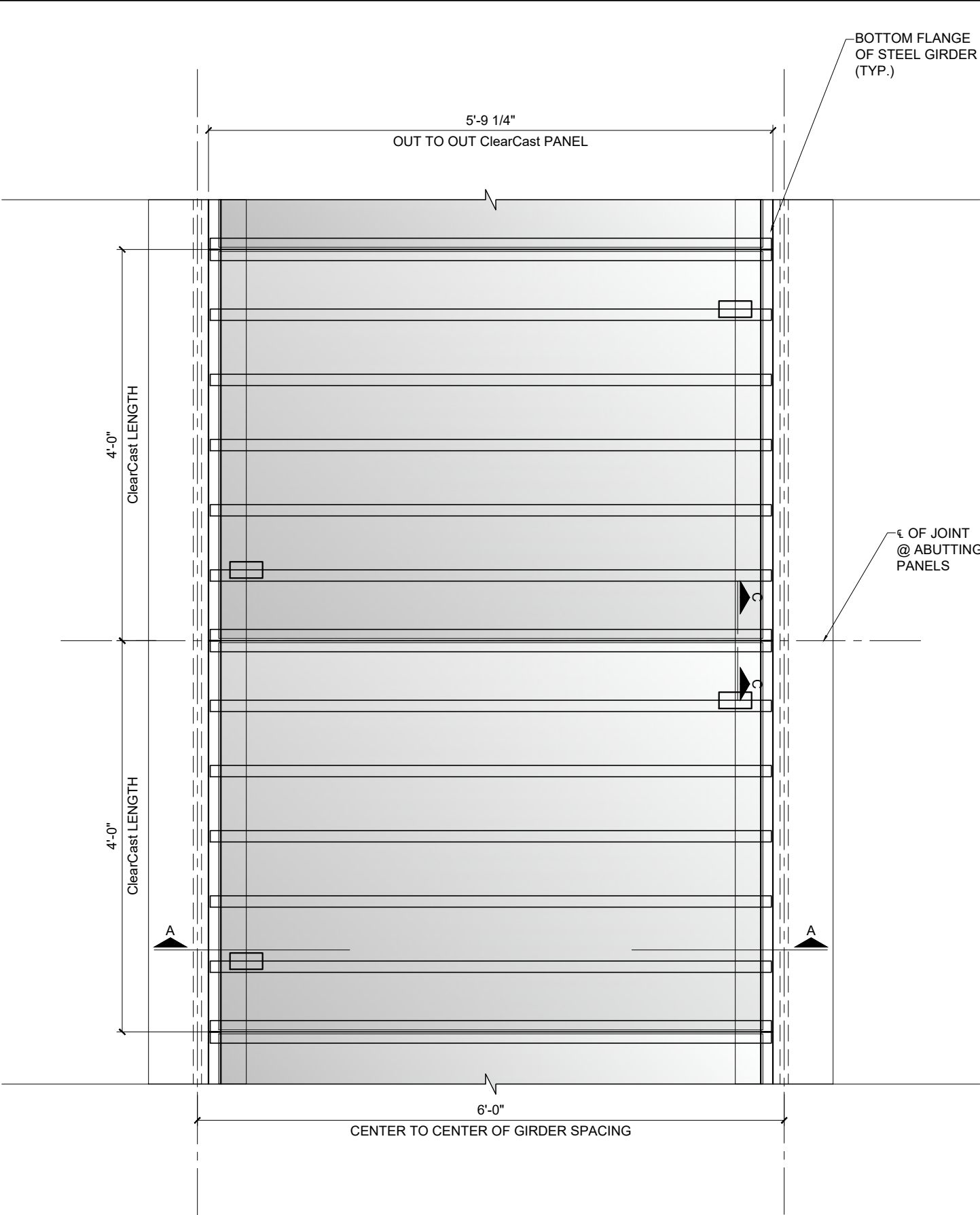

TYPICAL PLAN - ClearCatch PANELS (C-1)
NO SCALE

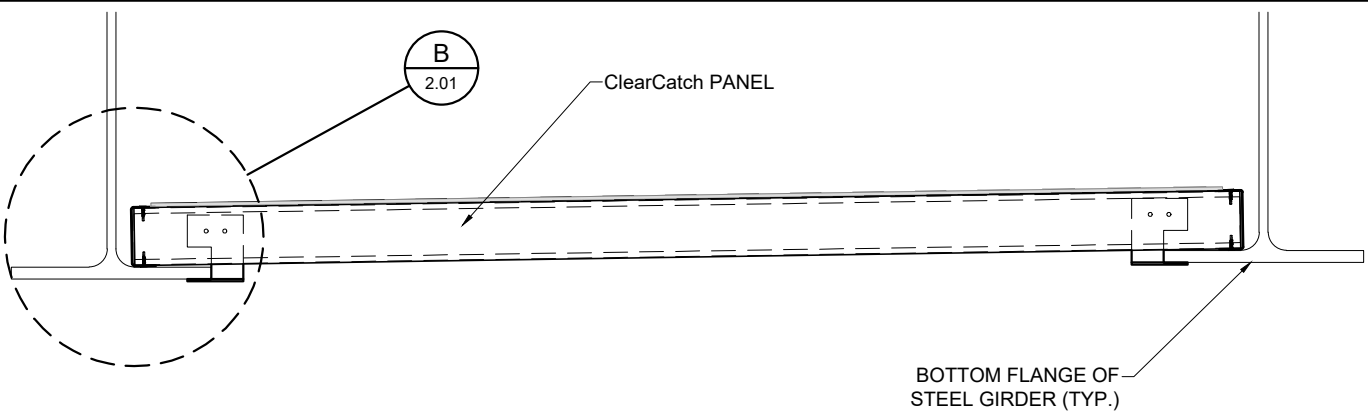

SECTION A - A
NO SCALE

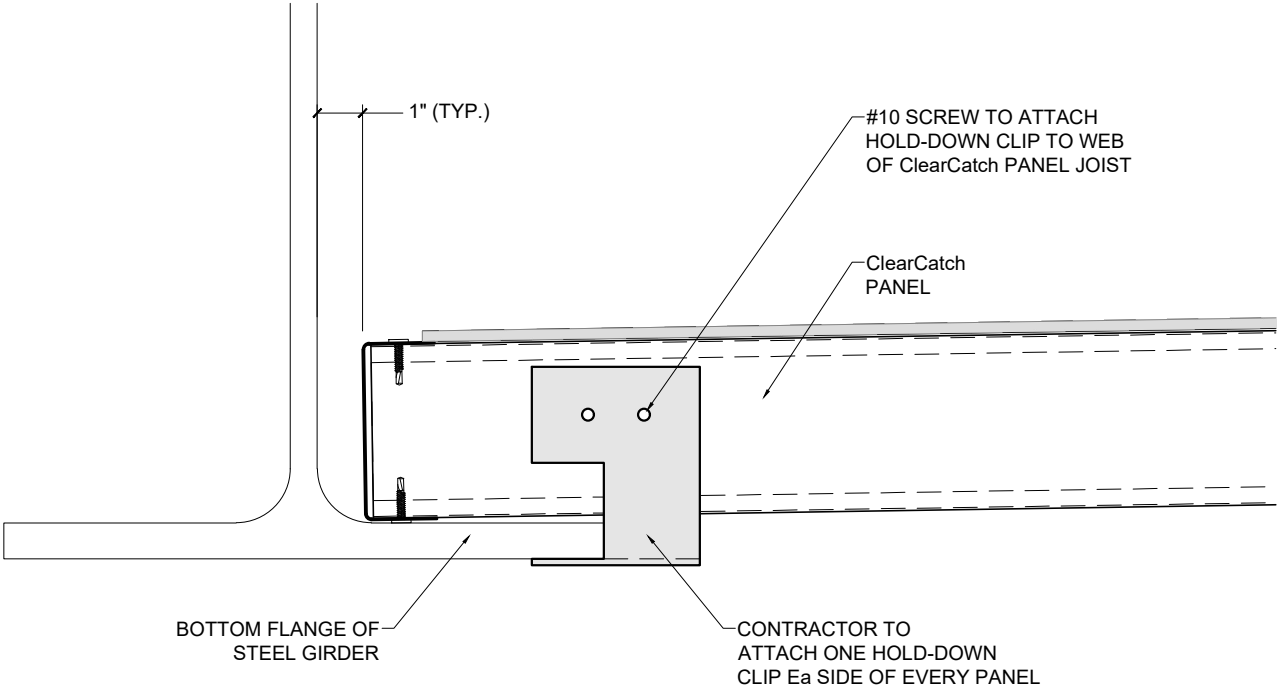

DETAIL B: PANEL SUPPORT
NO SCALE

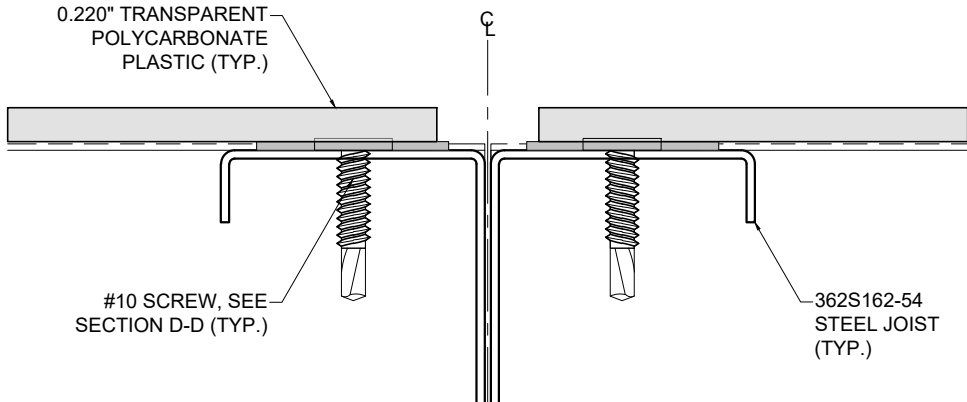

SECTION C - C: JOINT DETAIL
NO SCALE

NOTE: THIS DRAWING AND THE INFORMATION CONTAINED AND/OR DEPICTED HEREIN, EITHER EXPRESSLY OR IMPLIED, IS CONDITIONAL AND PROPRIETARY AND MAY NOT BE REUSED, REPRINTED, DISTRIBUTED OR OTHERWISE DISCLOSED WITHOUT THE EXPRESS WRITTEN CONSENT OF TRUETECH BRIDGE®, LLC.

PREPARED BY:
TrueTech Bridge®
740 Merritt Capital Drive - Suite 121
Wake Forest, NC 27587
Ph.: (855)200-8304

DESIGN BY: DB
DRAWN BY: SE
CHECKED BY: MP

PROJECT NAME:

ClearCatch - SAMPLE DRAWING

PATENT NUMBER: PENDING

ClearCatch Panels

PAGE NAME:

TYPICAL ClearCatch
INSTALLATION DETAILS

SUBMITTAL DATE:

01/31/2024

PROJECT NO.:

SET

PAGE #

S 2.01

COPYRIGHT 2022 TRUETECH BRIDGE®, LLC

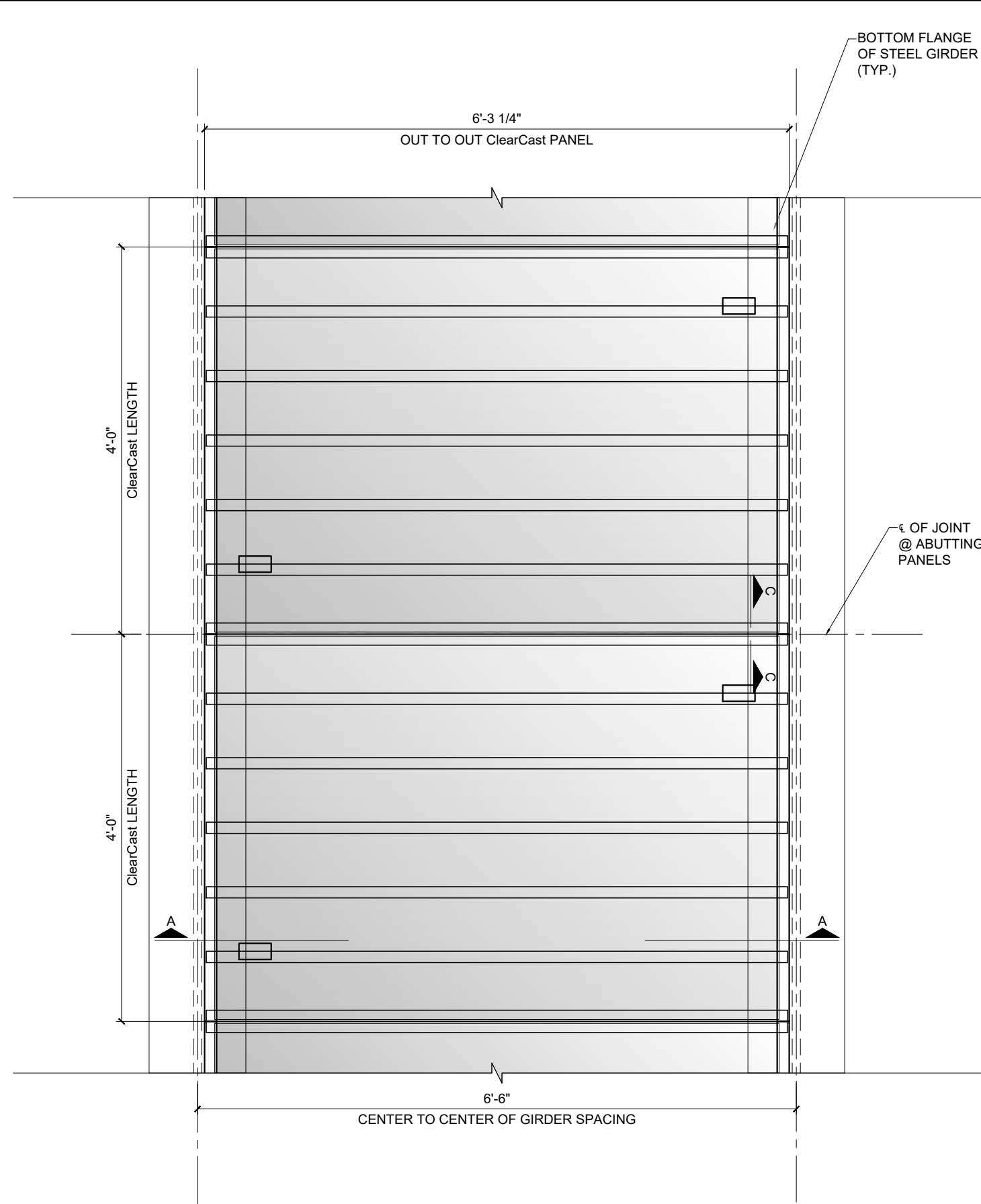

TYPICAL PLAN - ClearCatch PANELS (C-3)
NO SCALE

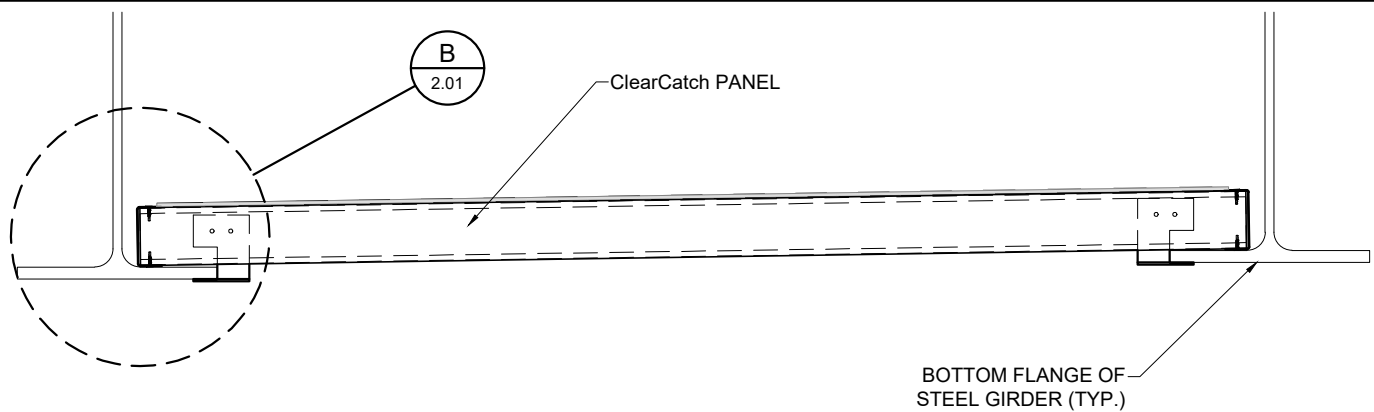

SECTION A - A
NO SCALE

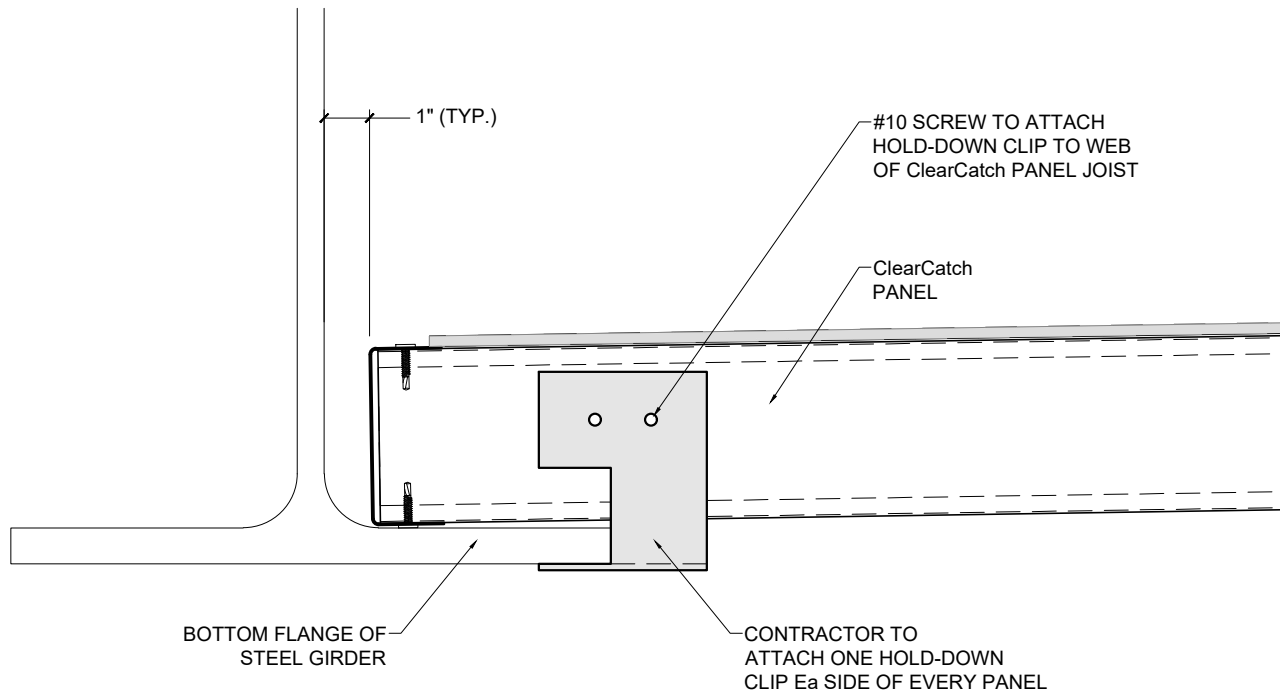

DETAIL B: PANEL SUPPORT
NO SCALE

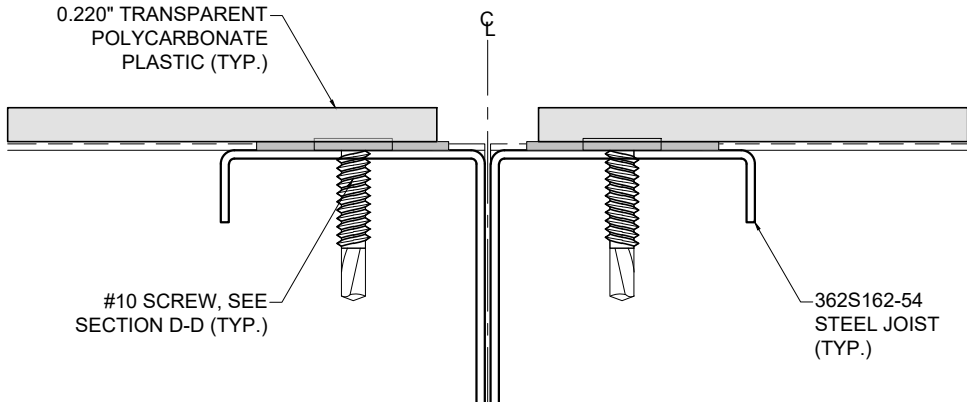

SECTION C - C: JOINT DETAIL
NO SCALE

NOTE: THIS DRAWING AND THE INFORMATION CONTAINED AND/OR DEPICTED HEREIN, EITHER EXPRESSLY OR IMPLIED, IS CONDITIONAL AND PROPRIETARY AND MAY NOT BE REUSED, REPRINTED, DISTRIBUTED OR OTHERWISE DISCLOSED WITHOUT THE EXPRESS WRITTEN CONSENT OF TRUETECH BRIDGE®, LLC.

PREPARED BY:
TrueTech Bridge®
740 Merritt Capital Drive - Suite 121
Wake Forest, NC 27587
Ph.: (855)200-8304

DESIGN BY: DB
DRAWN BY: SE
CHECKED BY: MP

PROJECT NAME:

ClearCatch - SAMPLE DRAWING

PATENT NUMBER: PENDING

ClearCatch Panels

PAGE NAME:

TYPICAL ClearCatch
INSTALLATION DETAILS

SUBMITTAL DATE:

01/31/2024

PROJECT NO.:

SET

PAGE #

S 2.02

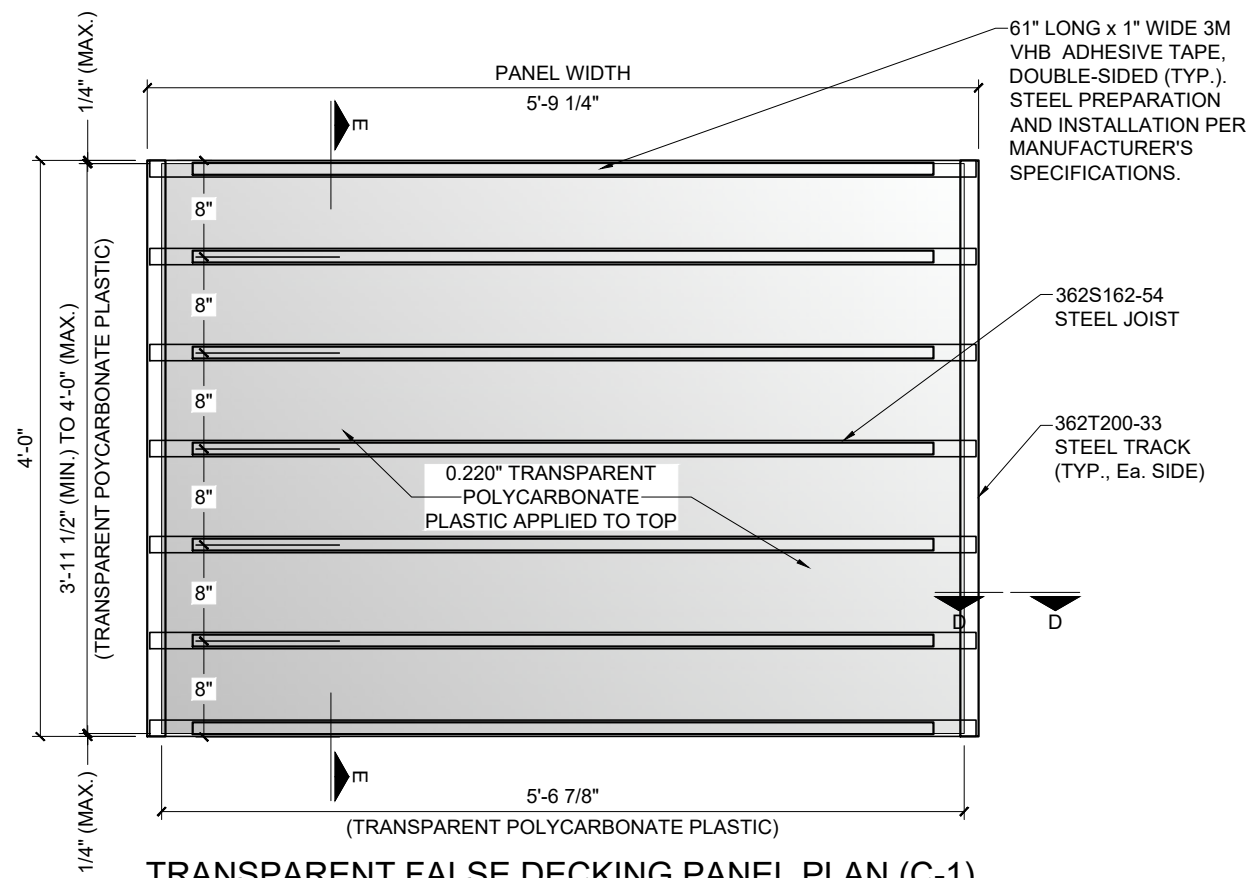

TRANSPARENT FALSE DECKING PANEL PLAN (C-1)
NO SCALE

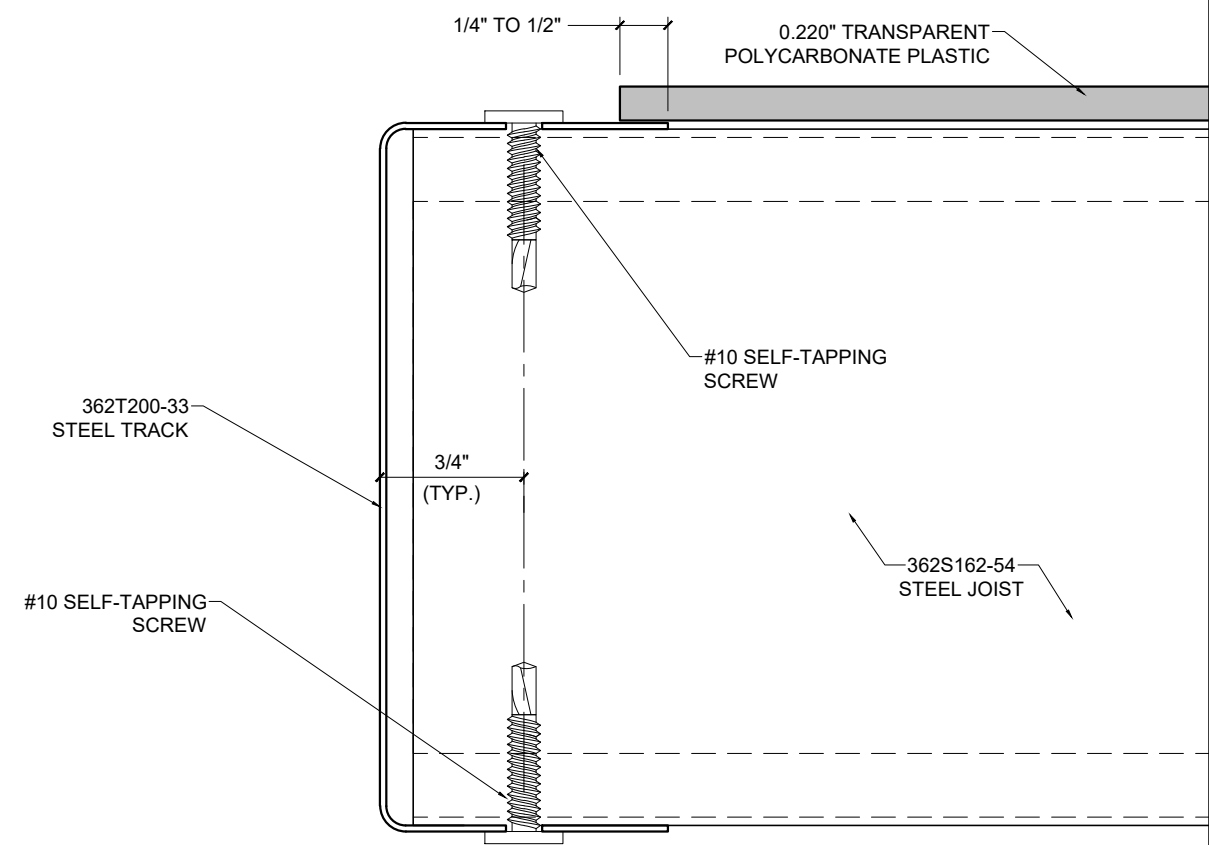

SECTION D-D
NO SCALE

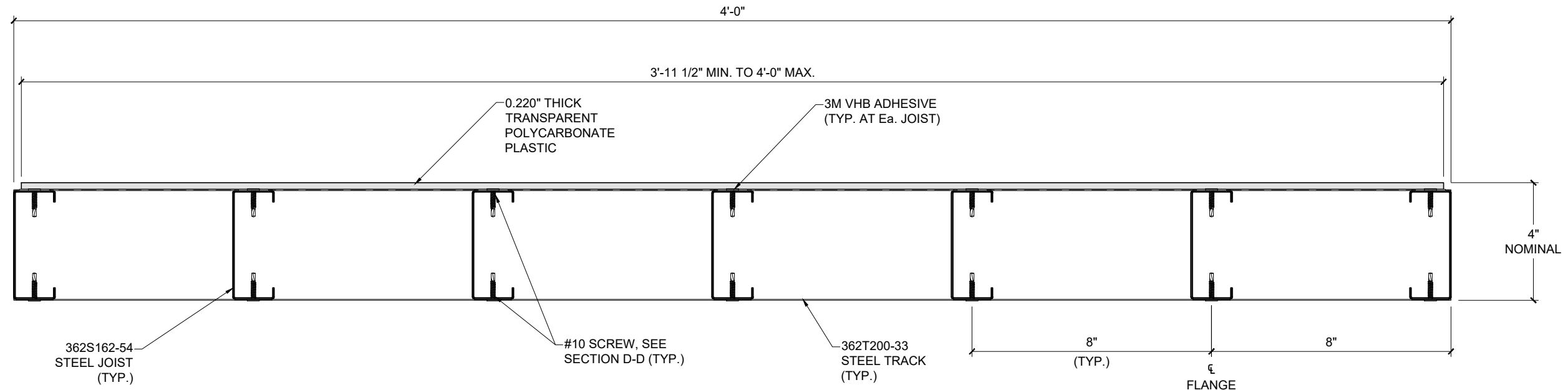

SECTION E-E
NO SCALE

COPYRIGHT 2022 TRUETECH BRIDGE®, LLC

COPYRIGHT 2022 TRUETECH BRIDGE®, LLC

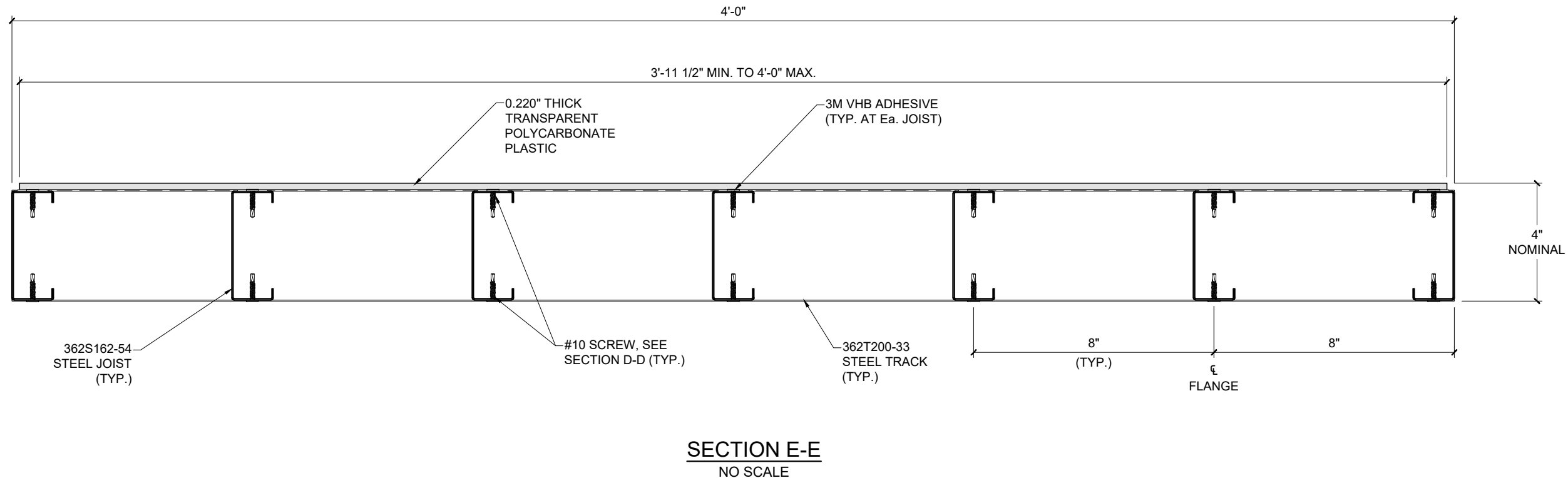
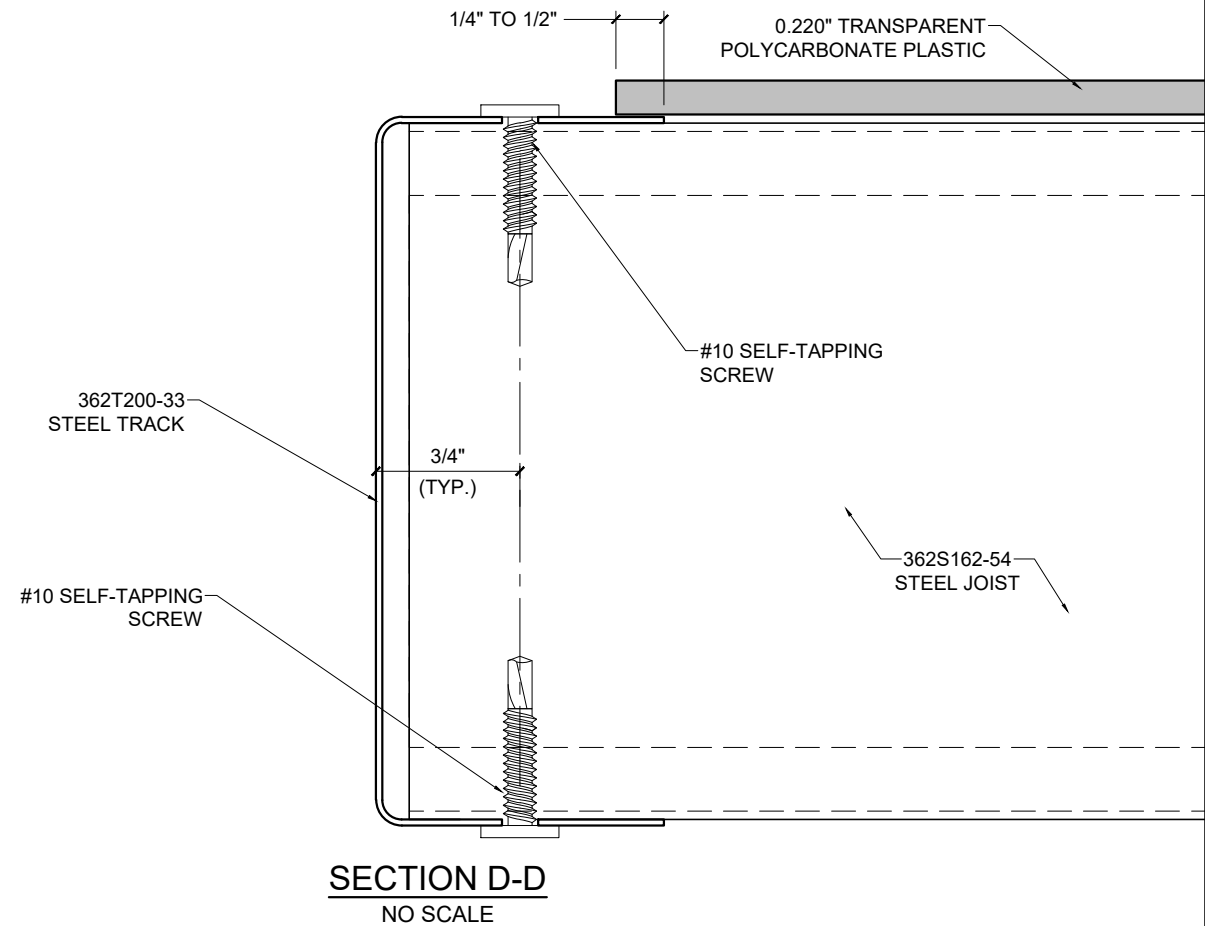
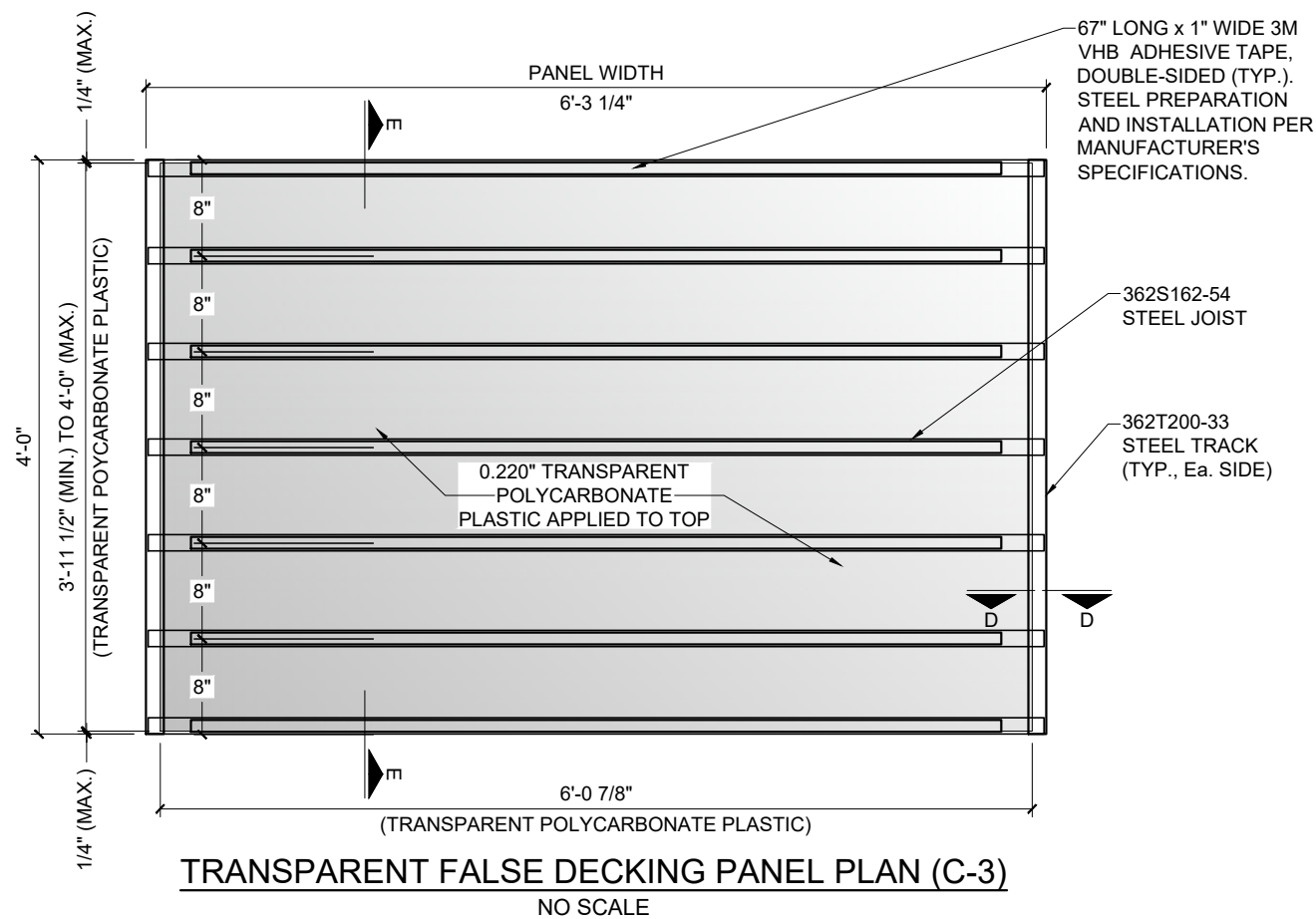

NOTE: THIS DRAWING AND THE INFORMATION CONTAINED AND/OR DEPICTED HEREIN, EITHER EXPRESSLY OR IMPLIED, IS CONDITIONAL AND PROPRIETARY AND MAY NOT BE REUSED, REPRINTED, DISTRIBUTED OR OTHERWISE DISCLOSED WITHOUT THE EXPRESS WRITTEN CONSENT OF TRUETECH BRIDGE®, LLC.

PREPARED BY:
TrueTech Bridge®
740 Merritt Capital Drive - Suite 121
Wake Forest, NC 27587
Ph.: (855)200-8304

DESIGN BY: DB
DRAWN BY: SE
CHECKED BY: MP

PROJECT NAME: PATENT NUMBER: PENDING

ClearCatch - SAMPLE DRAWING

ClearCatch Panels

STANDARD ClearCatch
ASSEMBLY DETAILS

SUBMITTAL DATE: 01/31/2024

PROJECT NO.:

SET

PAGE #

S 3.02

COPYRIGHT 2022 TRUETECH BRIDGE®, LLC

